

Lane restrictions information

Our request to all expressway users: Please drive safely.

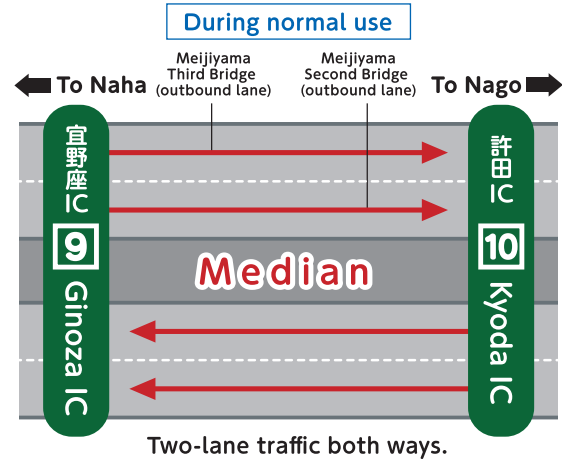

During two-lane restricted use

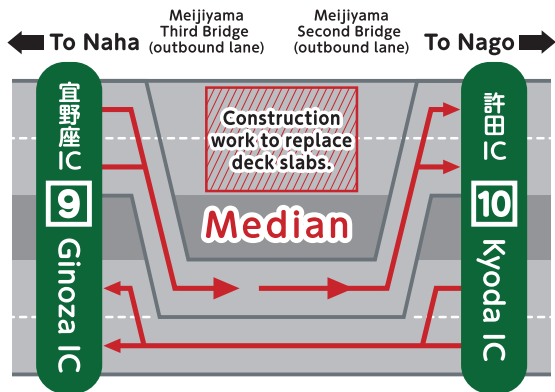

The four inbound and outbound lanes will be reduced to two lanes (two-way traffic) during deck slab replacement.
 ※ The construction area will be off-limits to traffic until all deck slabs are replaced and paving is completed.
 ※ Construction dates may be changed due to weather or other factors.

Deck slab replacement work concept



Because damaged deck slabs are removed, the road surface is temporarily missing. Replacement work is not complete until factory-manufactured deck slabs are installed and the surface is paved. As a result, traffic restrictions cannot be lifted until the deck slab replacement and paving operations are finished.

When changing lanes, change early and allow yourself plenty of time. Forcing your way into another lane is dangerous.

Just before the area with traffic restrictions, two lanes will be merged into one lane. Forcing your way into the lane at the last minute is **very dangerous**. When changing lanes, change early and allow yourself plenty of time.

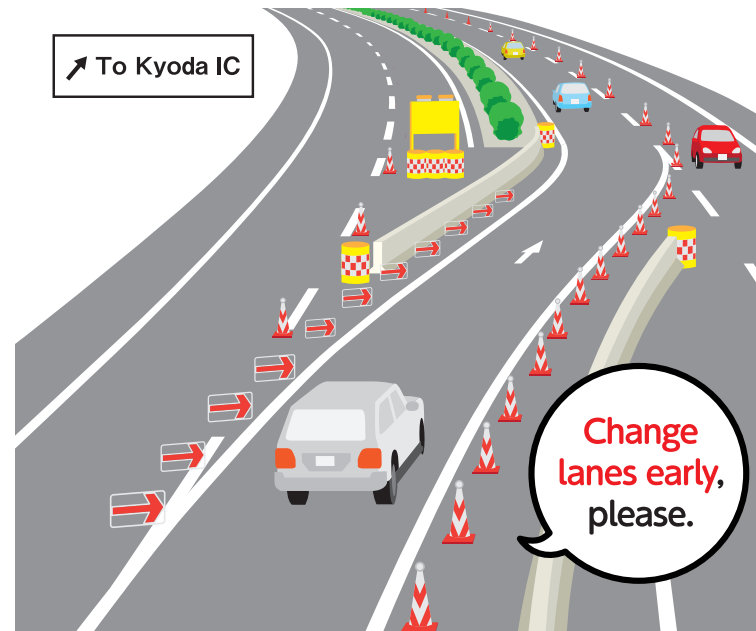

Watch for traffic congestion!



Okinawa Expressway

Meijiyama Second and Third Bridge renovation work



All-Day Two-Lane Restrictions



2015

1/8 [Th.] → 3/31 [Tu.]

Traffic congestion may occur, particularly in the mornings and evenings. Please factor potential delays into your travel time.



Information on peripheral roads for Okinawa Expressway Ginoza IC ↔ Kyoda IC two-lane restrictions

2015 1/8 (Th.) → 2015 3/31 (Tu.)

During restrictions, **traffic congestion may occur**, particularly in the **mornings and evenings**. We suggest using **National Highway 329 ~ Prefectural Highway 71** as peripheral roads. We apologize for the inconvenience, and request your patience and cooperation.

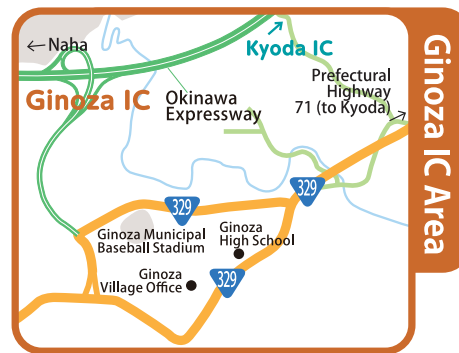

Road Information

Dedicated construction homepage

<http://www.navi-corn.com/okinawa2015>

During construction, detours and work content will be posted to a dedicated website.

Dedicated construction mobile site

<http://www.navi-corn.com/m-okinawa2015>

Construction content is also posted to a dedicated mobile site.



Construction questions? Contact:

NEXCO-West Kyushu Branch Okinawa Expressway Office Hours/Weekdays 9:00~17:00
098-876-8950 Main number
 Make sure to dial the correct number. While traffic restrictions are in place, inquiries will be accepted 24 hours a day.

For questions regarding expressway tolls and traffic information:

■ NEXCO-West Customer Center

0120-924863 **06-6876-9031** ※If you are unable to make "free-dial" calls, use this number:

English guidance available from 9:00a.m. to 5:00p.m.

Other convenient expressway information

■ Highway Telephone Service

8162 Number for cell phones (You'll be connected to the nearest district)

Get the latest highway traffic information 24 hours a day via Highway Telephone (recording). (The information is free, but you will be charged for the call.)

■ Japan Road Traffic Information Center

Okinawa Information : 050-3369-6647

■ iHighway (Highway traffic information on your cell phone)

<http://ihighway.jp>

View expressway traffic information 24 hours a day.

〈Smartphone app information〉

- Access the iHighway homepage and download from the "Download App" button.
- Download from Google play for Android and the iPhone App Store.



Make sure to dial the correct number.

Using your cell phone while driving is against the law. Use only at service/parking areas.

If you see something wrong on the road, call the roadway emergency number: **#9910**